

高压直流电源滤波器 High Voltage DC Power Supply Filter

产品特点 Features

良好的共模、差模抑制性，有效的抑制了电磁干扰。

Excellent attenuation performance to eliminate the common-mode and differential-mode EMI

特殊的设计，适于高压直流电源信号线。

Special design for high-voltage DC power line

便于安装。Easy to install

满足TUV认证 TUV approval

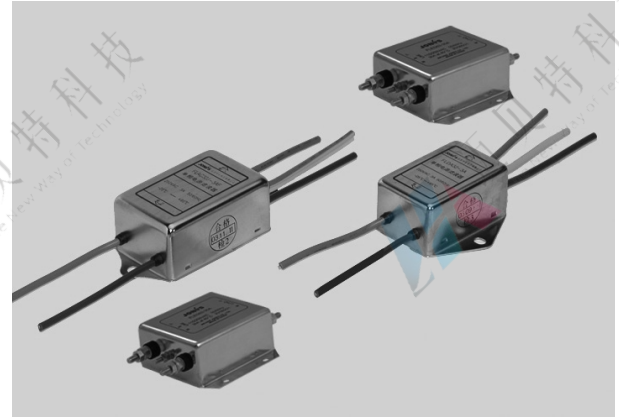

应用场合 Applications

切换式电源供应器，UPS等电力设备，多元化切换齿轮，SDH等设备。

Switch mode power supply UPS Switching gear multiplex SDH

规格表 Specification

产品型号 Filter P/N	端接方式 Connection		额定电流 Current rating	额定电压 Voltage rating	耐压等级 Stress levels	气候类别 Climatic category
	输入 Input	输出 Output				
FLAC32D-3A			3A	400 VDC	1768VDC, 1min (line/line); 2000VAC, 1 min (lines/case)	25/85/21
FLAC32D-6A			6A			
FLHD53D-10A			10A			
FLHD63D-20A			20A			
FLVBAJ-15SE			15A	1000 VDC	3500VDC, 5s (line/line); 3600VAC, 5s (lines/case)	
FLVBAJ-25SE			25A			
FLVBBJ-50SE			50A			
FLVBBJ-75SE			75A			
FLVBCNJ-100SE			100A			
FLVBDNJ-150SE			150A			
FLYAP8-250TE			250A			
FLVBEPP-250BE			250A			
FLVBFPP-400BE			400A			
FLVBFPP-600BE			600A			
FLVBGPP-800BE			800A			
FLVBGPP-1000BE			1000A			
FLNBRC-1000TH			1000A			
FLVBHPP-1500BE			1500A			

插入损耗 Insertion Loss

插入损耗是在标准50Ω系统条件下测定的 (typical values at Z=50Ω)

——共模CM common mode ——差模DM differential mode

FLAC32D-3A

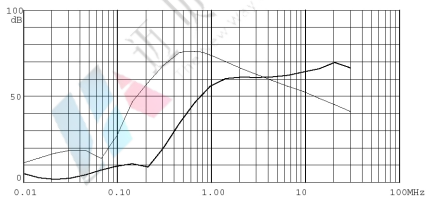

FLAC32D-6A

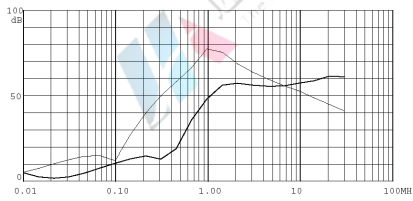

FLHD53D-10A

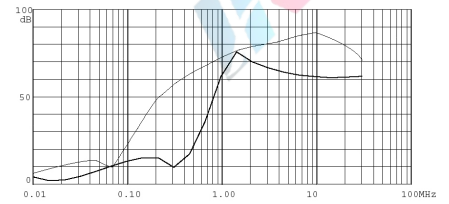

FLHD63D-20A

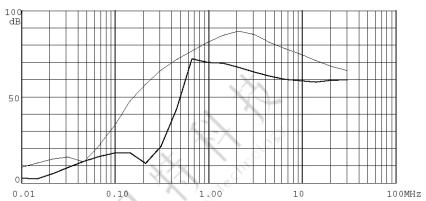

25 to 75A types

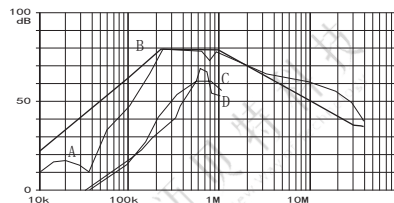

100 to 150A types

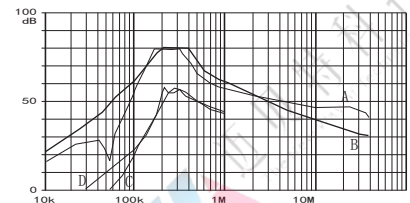

250A types

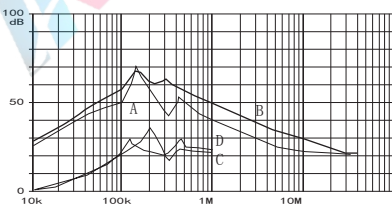

400 to 1500A types

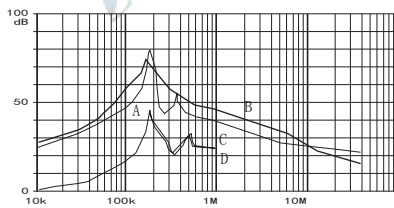

外形尺寸 单位 (mm) Dimensional Drawing (unit: mm)

FLAC32D-3A FLAC32D-6A

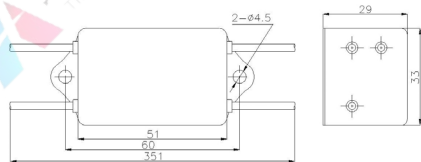

FLHD53D-10A

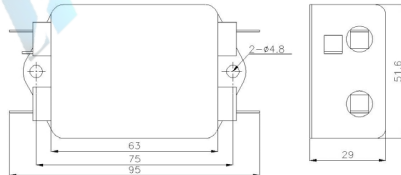

FLHD63D-20A

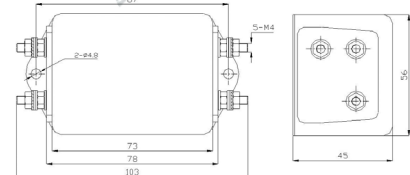

15A to 150A types

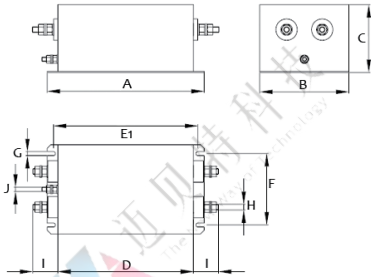

FLYAP8-250TE

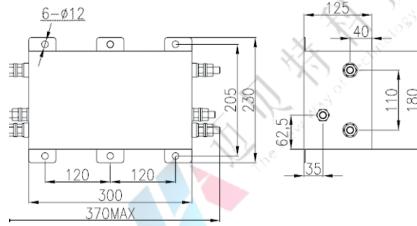

250A to 1500A types

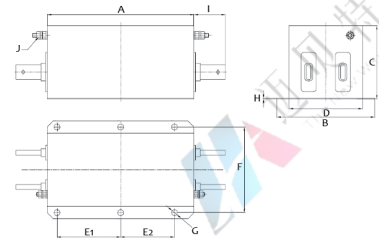

产品端子连接示意图

250 to 1000A types

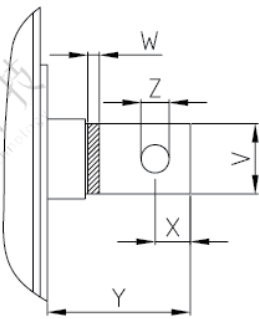

1500A types

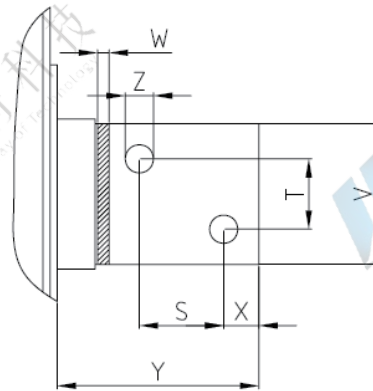

产品型号	结构尺寸 (mm)																		
	A	B	C	D	E1	E2	F	G	H	I	J	S	T	U	V	W	X	Y	Z
FLVBAJI-15SE	170	80	65	140	152.5	---	60	5.5	M5	25	M4	---	---	---	---	---	---	---	---
FLVBAJI-25SE	170	80	65	140	152.5	---	60	5.5	M5	25	M4	---	---	---	---	---	---	---	---
FLVBBJI-50SE	200	95	80	170	182.5	---	75	5.5	M6	39	M4	---	---	---	---	---	---	---	---
FLVBBJI-75SE	200	95	80	170	182.5	---	75	5.5	M8	39	M6	---	---	---	---	---	---	---	---
FLVBCNJ-100SE	220	125	95	190	202.5	---	100	5.5	M8	45	M6	---	---	---	---	---	---	---	---
FLYAP8-250TE	230	180	125	300	240	---	205	φ12	M10	40	M10	---	---	---	---	---	---	---	---
FLVBDNJ-150SE	250	140	115	220	232.5	---	120	5.5	M10	50	M8	---	---	---	---	---	---	---	---
FLVBEP-250BE	300	180	110	130	130	110	155	φ12	2	58	M10	---	---	70	20	5	15	58	φ9
FLVBFP-400BE	300	190	110	140	130	110	165	φ12	2	58	M10	---	---	70	25	6	15	58	φ10.5
FLVBFP-600BE	300	190	110	140	130	110	165	φ12	2	58	M10	---	---	70	25	8	15	58	φ10.5
FLVBGP-800BE	300	200	140	150	130	110	175	φ12	3	65	M12	---	---	70	40	8	20	65	φ14
FLVBGP-1000BE	300	200	140	150	130	110	175	φ12	3	65	M12	---	---	70	40	8	20	65	φ14
FLNBRC-1000TH	300	200	140	150	130	110	175	φ12	3	65	M12	---	---	70	40	8	20	65	φ14
FLVBHP-1500BE	300	200	150	150	130	110	175	φ12	3	100	M12	43	26	70	60	10	17	100	φ14